

WILLIAMSON COUNTY

CR 110 SOUTH SECTION PRECINCT NUMBER 4

NET LENGTH OF ROADWAY = 11,667.00 FT (2.210 MILES)
NET LENGTH OF BRIDGE = 124.00 FT (0.023 MILES)
NET LENGTH OF PROJECT = 11,791.00 FT (2.233 MILES)

LIMITS: FROM US 79 TO NORTH OF LIMMER LOOP

FOR THE CONSTRUCTION OF THREE LANE FACILITY WITH CONTINUOUS LEFT TURN
CONSISTING OF: PAVING, GRADING, BRIDGE, DRAINAGE, RETAINING WALLS,
SIGNING AND PAVEMENT MARKING.

ROADWAY	CLASSIFICATION	DESIGN SPEED
COUNTY ROAD 110	MINOR URBAN ARTERIAL	45 MPH
LIMMER LOOP	MINOR URBAN ARTERIAL	45 MPH
COUNTY ROAD 122	MINOR RURAL ARTERIAL	40 MPH

ROADWAY	A.D.T. (2015)	A.D.T. (2035)
COUNTY ROAD 110	3,100	11,100
LIMMER LOOP	3,700	10,100
COUNTY ROAD 122	5,200	8,500

100% SUBMITTAL



APPROVED BY:
WILLIAMSON COUNTY

Dan A. Gattis 08-09-2016
DATE
DAN A GATTIS
WILLIAMSON COUNTY JUDGE

APPROVED BY:
WILLIAMSON COUNTY

Ron Morrison
DATE
RON MORRISON
WILLIAMSON COUNTY COMMISSIONER, PRECINCT 4

APPROVED BY:
HNTB CORPORATION

Richard L. Ridings 8/9/16
DATE
RICHARD L RIDINGS, PE
ROAD BOND MANAGER

INDEX OF SHEETS

SHEET NO.	DESCRIPTION
1	TITLE SHEET
2	INDEX OF SHEETS (SEE SHEET 2 FOR DETAILED INDEX OF SHEETS)

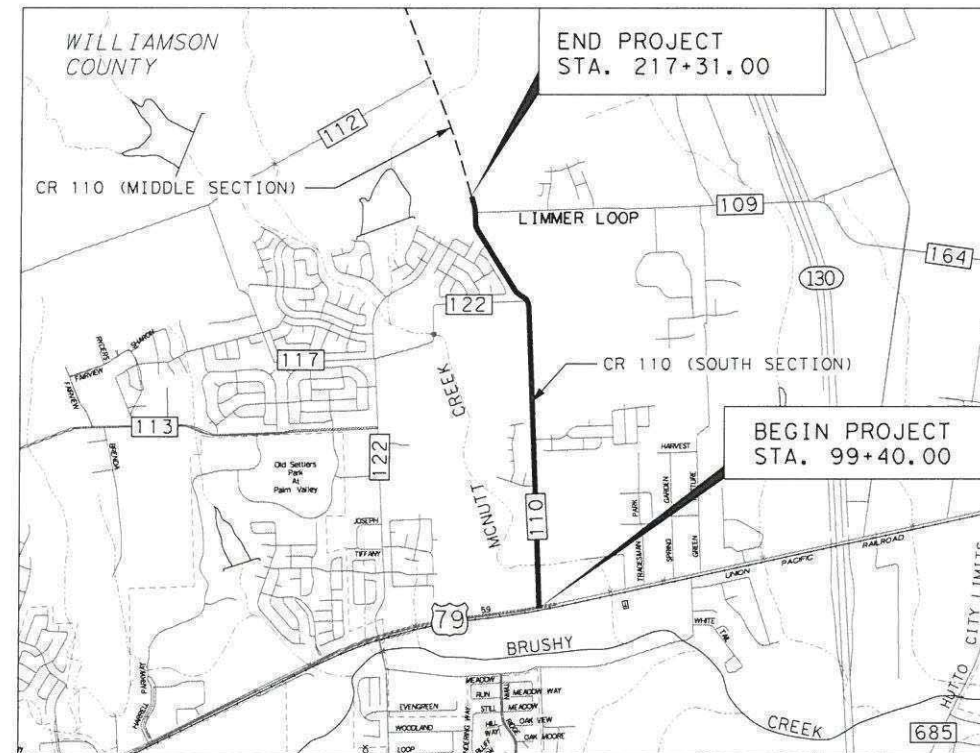

VICINITY MAP
N. T. S.

EXCEPTIONS: NONE
EQUATIONS: NONE
RAILROAD CROSSINGS: NONE
WATERSHED: MCNUTT CREEK
AREA OF DISTURBANCE: 42.5 ACRES

REQUIRED SIGNS SHALL BE PLACED IN ACCORDANCE WITH STANDARD SHEETS BC(1)-14 THRU BC(12)-14 AND THE "TEXAS MANUAL ON UNIFORM TRAFFIC CONTROL DEVICES.:"

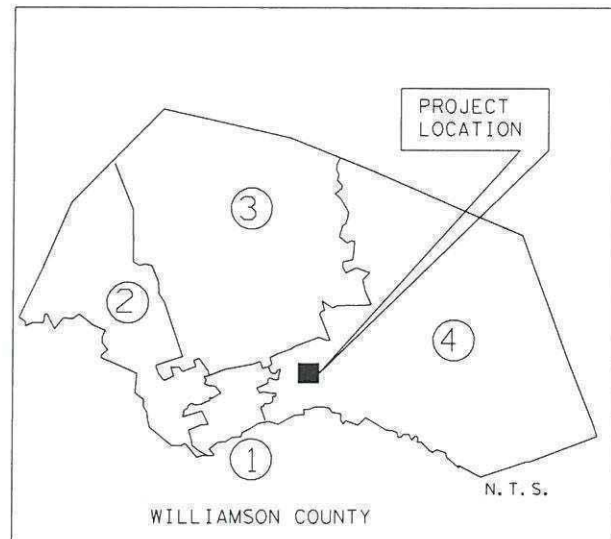

DANNENBAUM
ENGINEERING COMPANY - AUSTIN, LLC
T.B.P.E. FIRM REGISTRATION #8995
3409 EXECUTIVE CENTER DR., STE 129 AUSTIN, TX 78731 (512) 345-8505

PREPARED BY:
DANNENBAUM ENGINEERING COMPANY - AUSTIN, LLC (DESIGN CONSULTANT)

Tommy G. Levario 5-23-16
DATE
TOMMY G. LEVARIO
PROJECT MANAGER



TxDOT STANDARD SPECIFICATIONS FOR CONSTRUCTION OF HIGHWAYS, STREETS AND BRIDGES ADOPTED ON NOVEMBER 1, 2014 AND ALL APPLICABLE SPECIAL PROVISIONS AND SPECIAL SPECIFICATIONS AS INDICATED IN THE BID DOCUMENTS SHALL GOVERN ON THIS PROJECT.

FILE: p:\us-hou-pw01.dannenbaum.local\1.dannenbaum\Documents\Transport\4862-01\Design\Sign\4862\TP01
 DATE: 5/23/2016 TIME: 2:58:57 PM USER: nojib.ozugogoh

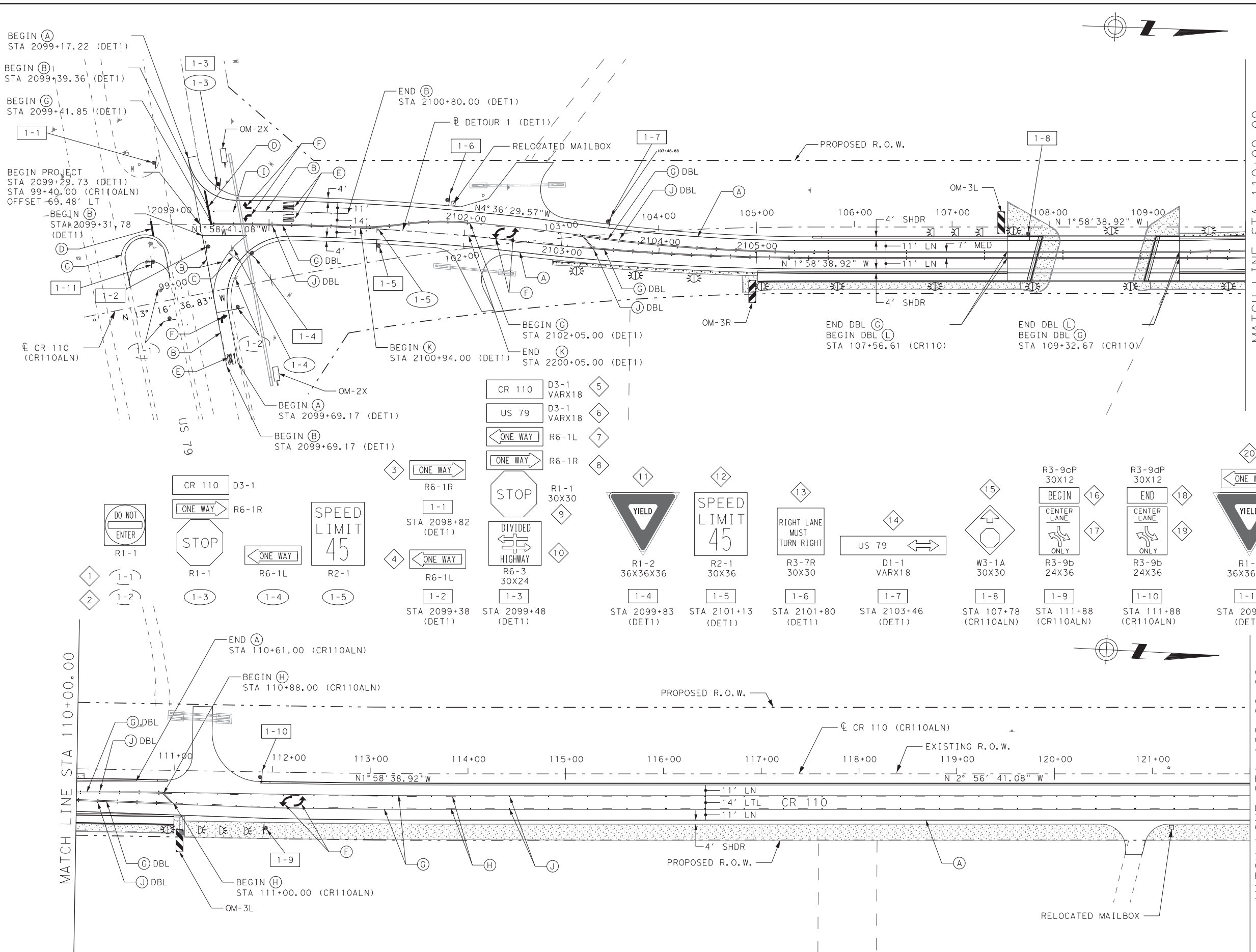

- LEGEND**
- XX SIGN NUMBER
 - X-X PROPOSED SIGNS
 - X-X EXISTING SIGN TO BE REMOVED
 - X-X EXISTING SIGN TO BE RELOCATED
 - (A) REFLECTOR PAVEMENT MARKING TY I (W) (4") (SLD)
 - (B) REFLECTOR PAVEMENT MARKING TY I (W) (8") (SLD)
 - (C) REFLECTOR PAVEMENT MARKING TY I (W) (36") (YLD TRI)
 - (D) REFLECTOR PAVEMENT MARKING TY I (W) (24") (SLD)
 - (E) REFLECTOR PAVEMENT MARKING TY I (W) (WORD)
 - (F) REFLECTOR PAVEMENT MARKING TY I (W) (ARROW)
 - (G) REFLECTOR PAVEMENT MARKING TY I (Y) (4") (SLD)
 - (H) REFLECTOR PAVEMENT MARKING TY I (Y) (4") (BRK)
 - (I) RAISED PAVEMENT MARKING CL B (REFL) TY I-C
 - (J) RAISED PAVEMENT MARKING CL B (REFL) TY II-A-A
 - (K) REFLECTOR PAVEMENT MARKING TY I (W) 8" (DOT)
 - (L) REFLECTOR PAVEMENT MARKING TY II (Y) (4") (SLD)
 - X-D BI-DIRECTIONAL DELINEATOR
 - X DELINEATOR
 - OM-2 OBJECT MARKER (OM-2)
 - OM-3 OBJECT MARKER (OM-3)

- NOTES:**
- FINAL LOCATION OF ALL PROPOSED SIGNS MAY BE ADJUSTED IN THE FIELD AS DIRECTED BY THE ENGINEER.
 - UNLESS OTHERWISE NOTED, EXISTING SIGNS TO REMAIN IN PLACE.

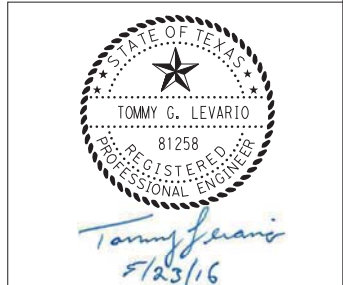
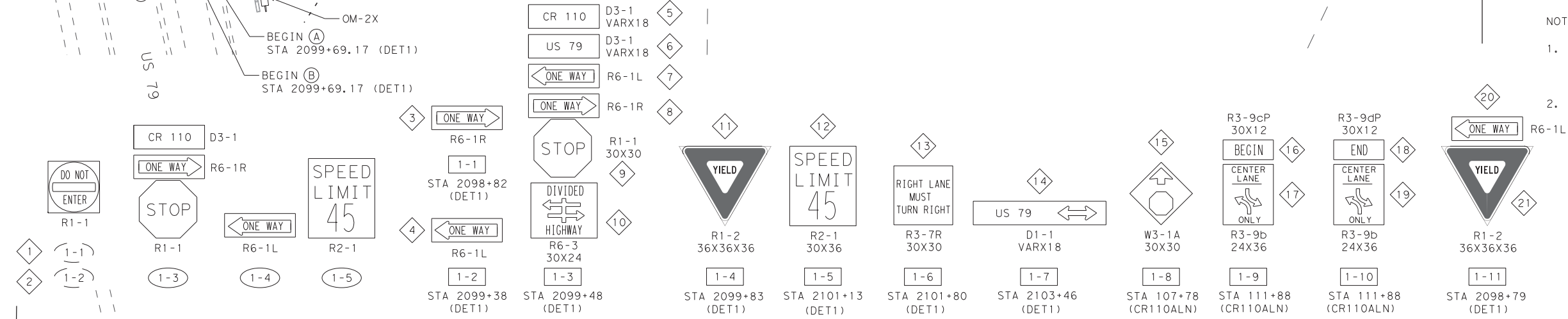
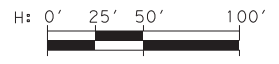

DATE	BY	REV	REVISION

DANNENBAUM
 ENGINEERING COMPANY - AUSTIN, LLC
 T.B.P.E. FIRM REGISTRATION #8995
 3409 EXECUTIVE CENTER DR., STE 129 AUSTIN, TX 78731 (512) 345-8505

© 2015 BY WILLIAMSON COUNTY, TEXAS; ALL RIGHTS RESERVED.

**CR 110 SOUTH
 PAVEMENT
 MARKINGS AND
 SIGNING PLANS**

BEGIN TO STA 122+00
 SCALE: HORIZONTAL 1"=100'
 SHEET 1 OF 6

DESIGNED:	TGL		
DRAWN:	PRP		
CHECKED:	GV		
STATE	COUNTY	PRECINCT	SHEET NO.
TEXAS	WILLIAMSON	4	238

FILE: pw\us-hou-pw01.dannenbaum.local\1.dannenbaum\Documents\Transport\4862-01\Design\Sign\Str\ip\ing\4862STP02
 DATE: 5/23/2016 TIME: 2:59:00 PM USER: nojib.ozugogh

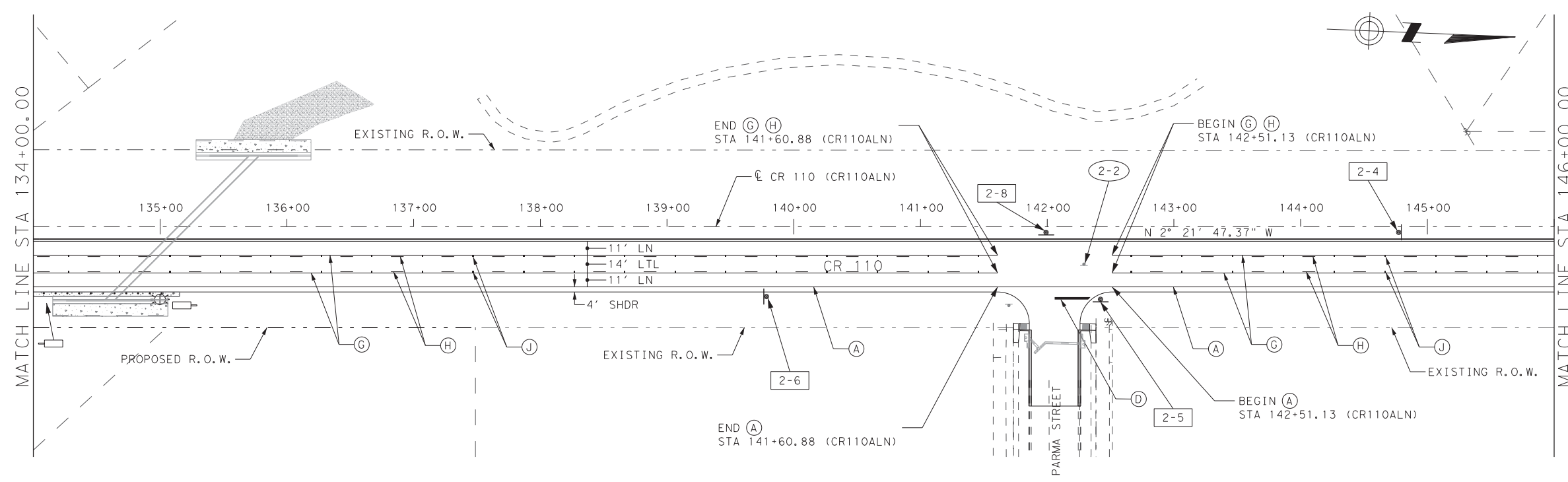
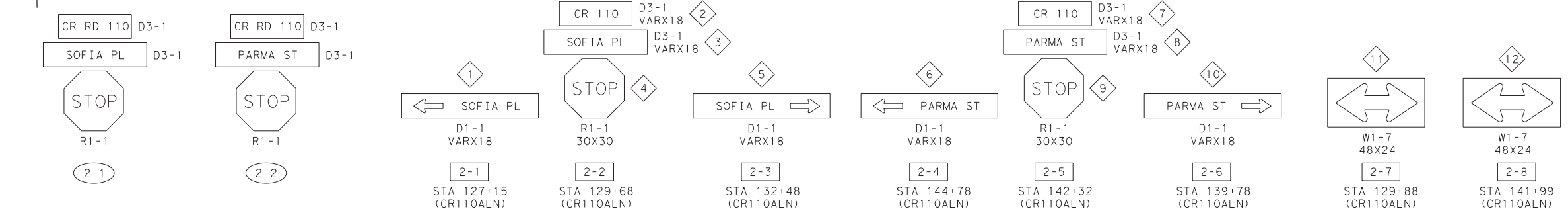
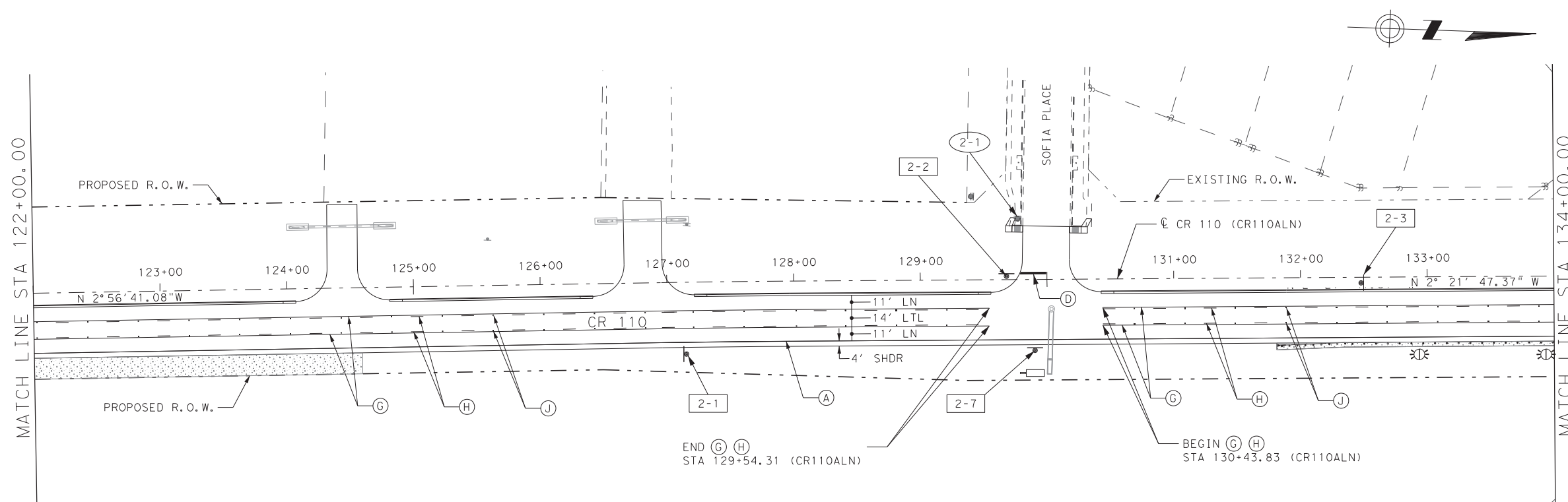

- LEGEND**
- XX SIGN NUMBER
 - X-X PROPOSED SIGNS
 - X-X EXISTING SIGN TO BE REMOVED
 - X-X EXISTING SIGN TO BE RELOCATED
 - A REFL PAV MRK TY I (W) (4") (SLD)
 - B REFL PAV MRK TY I (W) (8") (SLD)
 - C REFL PAV MRK TY I (W) (36") (YLD TRI)
 - D REFL PAV MRK TY I (W) (24") (SLD)
 - E REFL PAV MRK TY I (W) (WORD)
 - F REFL PAV MRK TY I (W) (ARROW)
 - G REFL PAV MRK TY I (Y) (4") (SLD)
 - H REFL PAV MRK TY I (Y) (4") (BRK)
 - I RAISED PAV MRK CL B (REFL) TY I-C
 - J RAISED PAV MRK CL B (REFL) TY II-A-A
 - K REFL PAV MRK TY I (W) 8" (DOT)
 - L REFL PAV MRK TY II (Y) (4") (SLD)
 - BI-DIRECTIONAL DELINEATOR
 - DELINEATOR
 - OBJECT MARKER (OM-2)
 - OBJECT MARKER (OM-3)

- NOTES:**
- FINAL LOCATION OF ALL PROPOSED SIGNS MAY BE ADJUSTED IN THE FIELD AS DIRECTED BY THE ENGINEER.
 - UNLESS OTHERWISE NOTED, EXISTING SIGNS TO REMAIN IN PLACE.

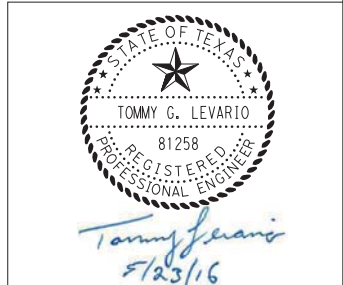
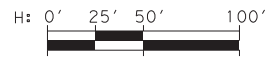

DATE	BY	REV	REVISION

DANNENBAUM
 ENGINEERING COMPANY - AUSTIN, LLC
 T.B.P.E. FIRM REGISTRATION #8995
 3409 EXECUTIVE CENTER DR., STE 129 AUSTIN, TX 78731 (512) 345-8505

© 2015 BY WILLIAMSON COUNTY, TEXAS; ALL RIGHTS RESERVED.

**CR 110 SOUTH
 PAVEMENT
 MARKINGS AND
 SIGNING PLANS**

STA 122+00 TO STA 146+00
 SCALE: HORIZONTAL 1"=100'

SHEET 2 OF 6

DESIGNED:	TGL		
DRAWN:	PRP		
CHECKED:	GV		
STATE:	COUNTY:	PRECINCT:	SHEET NO.:
TEXAS	WILLIAMSON	4	239

FILE: p:\us-hou-pw01.dannenbaum.local\1.dannenbaum\Documents\Transport\ton\4862-01\Design\Sign\tr\ip\ing\4862STP03
 DATE: 5/23/2016 TIME: 2:59:04 PM USER: ncj\ib.ozougogh

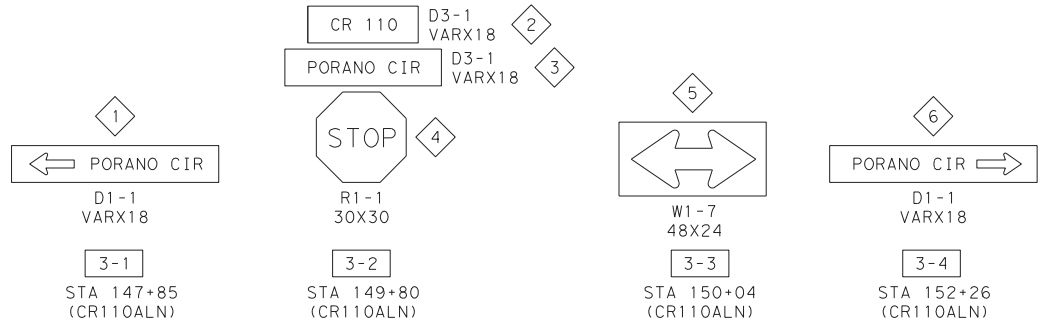
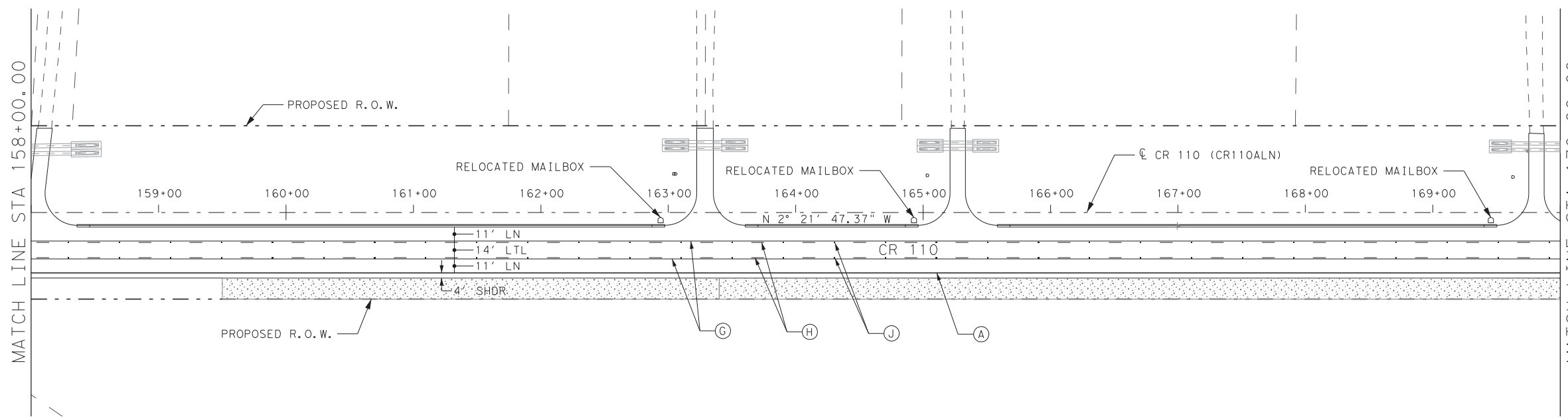
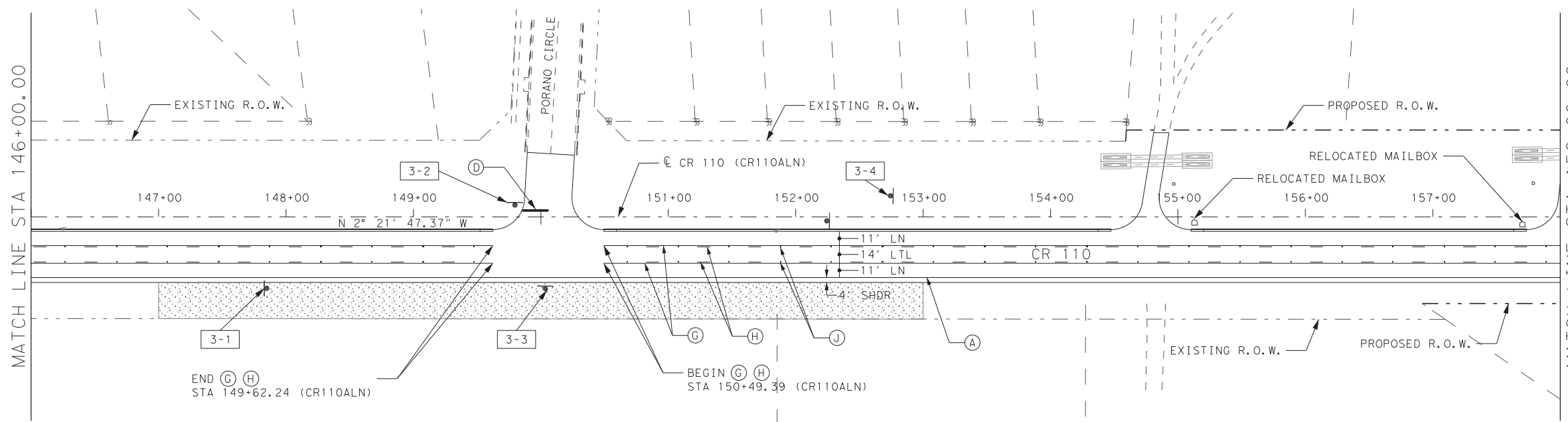

- LEGEND**
- XX SIGN NUMBER
 - X-X PROPOSED SIGNS
 - X-X EXISTING SIGN TO BE REMOVED
 - X-X EXISTING SIGN TO BE RELOCATED

- A REFL PAV MRK TY I (W) (4") (SLD)
- B REFL PAV MRK TY I (W) (8") (SLD)
- C REFL PAV MRK TY I (W) (36") (YLD TRI)
- D REFL PAV MRK TY I (W) (24") (SLD)
- E REFL PAV MRK TY I (W) (WORD)
- F REFL PAV MRK TY I (W) (ARROW)
- G REFL PAV MRK TY I (Y) (4") (SLD)
- H REFL PAV MRK TY I (Y) (4") (BRK)
- I RAISED PAV MRK CL B (REFL) TY I-C
- J RAISED PAV MRK CL B (REFL) TY II-A-A
- K REFL PAV MRK TY I (W) 8" (DOT)
- L REFL PAV MRK TY II (Y) (4") (SLD)
- X BI-DIRECTIONAL DELINEATOR
- X DELINEATOR
- OBJECT MARKER (OM-2)
- OBJECT MARKER (OM-3)

- NOTES:**
- FINAL LOCATION OF ALL PROPOSED SIGNS MAY BE ADJUSTED IN THE FIELD AS DIRECTED BY THE ENGINEER.
 - UNLESS OTHERWISE NOTED, EXISTING SIGNS TO REMAIN IN PLACE.

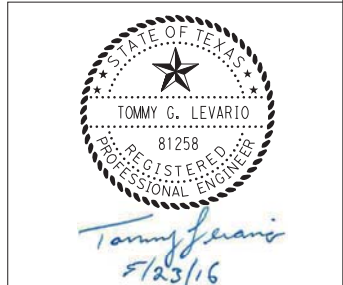
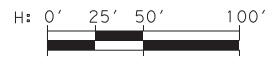

DATE	BY	REV	REVISION

DANNENBAUM
 ENGINEERING COMPANY - AUSTIN, LLC
 T.B.P.E. FIRM REGISTRATION #8995
 3409 EXECUTIVE CENTER DR., STE 129 AUSTIN, TX 78731 (512) 345-8505

© 2015 BY WILLIAMSON COUNTY, TEXAS; ALL RIGHTS RESERVED.
WILLIAMSON COUNTY

**CR 110 SOUTH
 PAVEMENT
 MARKINGS AND
 SIGNING PLANS**

STA 146+00 TO STA 170+00
 SCALE: HORIZONTAL 1"=100'

SHEET 3 OF 6

DESIGNED:	TGL		
DRAWN:	PRP		
CHECKED:	GV		
STATE:	COUNTY:	PRECINCT:	SHEET NO.:
TEXAS	WILLIAMSON	4	240

FILE: p:\us-hou-pw01.dannenbaum\local\1.dannenbaum\Documents\Transport\4862-01\Design\Str\p\ing\48625TP04
 DATE: 5/23/2016 TIME: 2:59:07 PM USER: nojib.ozugogogh

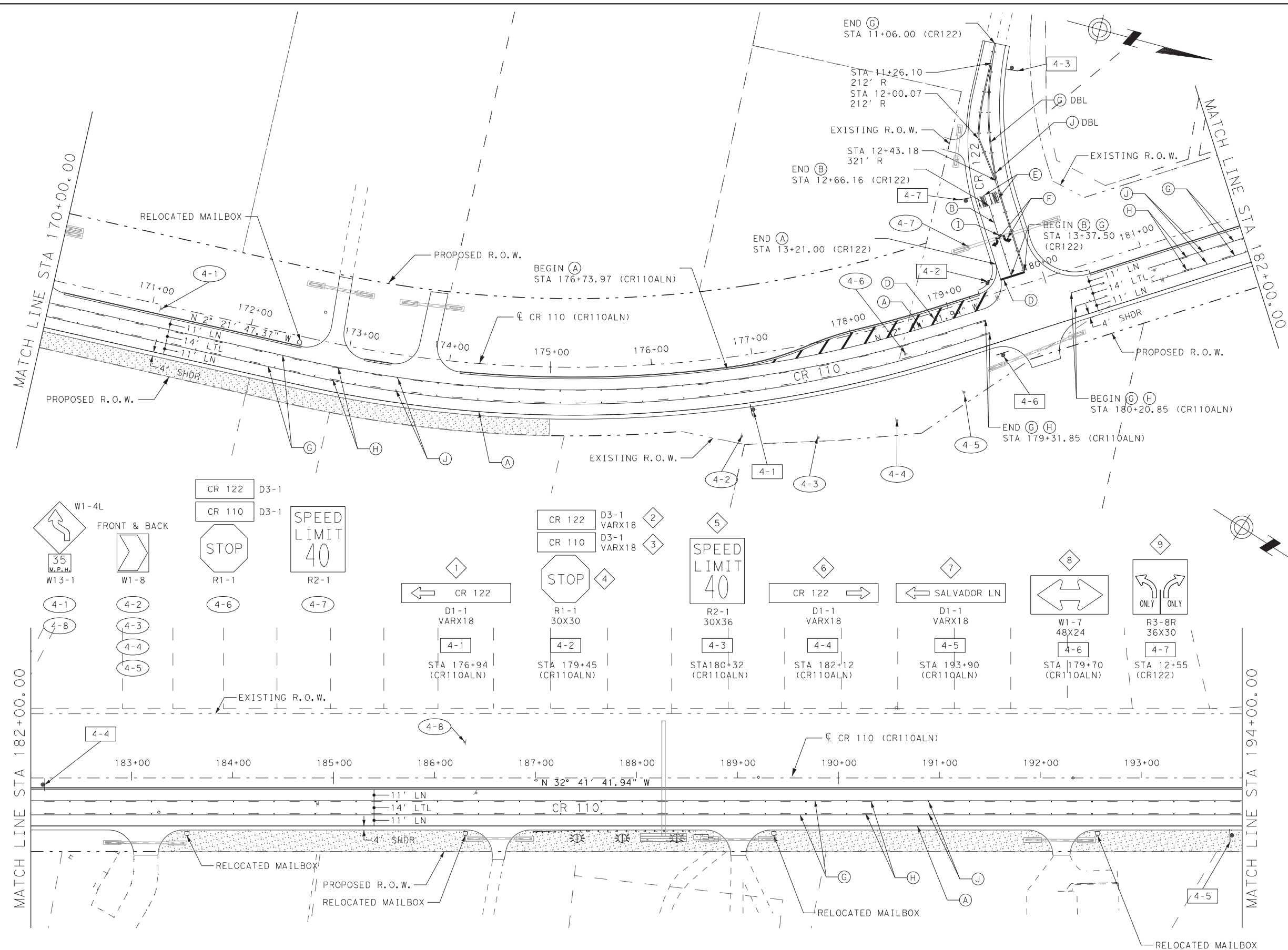

- LEGEND**
- XX SIGN NUMBER
 - X-X PROPOSED SIGNS
 - X-X EXISTING SIGN TO BE REMOVED
 - X-X EXISTING SIGN TO BE RELOCATED
 - A REFL PAV MRK TY I (W) (4") (SLD)
 - B REFL PAV MRK TY I (W) (8") (SLD)
 - C REFL PAV MRK TY I (W) (36") (YLD TRI)
 - D REFL PAV MRK TY I (W) (24") (SLD)
 - E REFL PAV MRK TY I (W) (WORD)
 - F REFL PAV MRK TY I (W) (ARROW)
 - G REFL PAV MRK TY I (Y) (4") (SLD)
 - H REFL PAV MRK TY I (Y) (4") (BRK)
 - I RAISED PAV MRK CL B (REFL) TY I-C
 - J RAISED PAV MRK CL B (REFL) TY II-A-A
 - K REFL PAV MRK TY I (W) 8" (DOT)
 - L REFL PAV MRK TY II (Y) (4") (SLD)
 - BI-DIRECTIONAL DELINEATOR
 - DELINEATOR
 - OBJECT MARKER (OM-2)
 - OBJECT MARKER (OM-3)

- NOTES:**
- FINAL LOCATION OF ALL PROPOSED SIGNS MAY BE ADJUSTED IN THE FIELD AS DIRECTED BY THE ENGINEER.
 - UNLESS OTHERWISE NOTED, EXISTING SIGNS TO REMAIN IN PLACE.

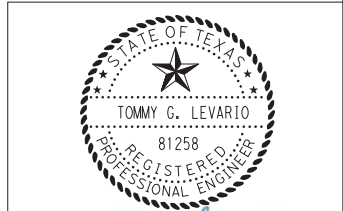
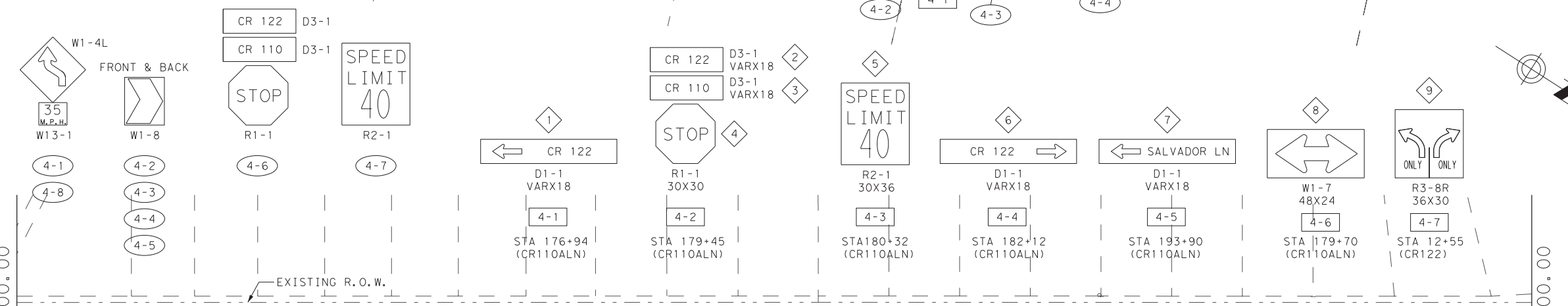
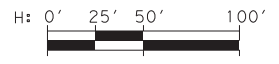

DATE	BY	REV	REVISION

DANNENBAUM
 ENGINEERING COMPANY - AUSTIN, LLC
 T.B.P.E. FIRM REGISTRATION #8995
 3409 EXECUTIVE CENTER DR., STE 129 AUSTIN, TX 78731 (512) 345-8505

© 2015 BY WILLIAMSON COUNTY, TEXAS; ALL RIGHTS RESERVED.

**CR 110 SOUTH
 PAVEMENT
 MARKINGS AND
 SIGNING PLANS**

STA 176+00 TO STA 194+00
 SCALE: HORIZONTAL 1"=100'

SHEET 4 OF 6

DESIGNED:	TGL		
DRAWN:	PRP		
CHECKED:	GV		
STATE:	COUNTY:	PRECINCT:	SHEET NO.:
TEXAS	WILLIAMSON	4	241

FILE: pw:\us-hou-pw01.dannbaum.local\dannbaum\Documents\Transportation\4862-01\Des\ign\str\ip\img\48625TP05
 DATE: 11/11/2016 TIME: 1:07:07 PM USER: nojib.azougagh

* CONTINUE TWLTL PAVEMENT MARKINGS FROM STA 200+07 TO STA 204+94 OR INSTALL LEFT TURN PAVEMENT MARKINGS (SHOWN) AS DIRECTED BY THE COUNTY OBSERVER OR GEC DEPENDING ON WHETHER LIMMER LOOP WESTBOUND EXTENSION HAS BEEN CONSTRUCTED. ADDITIONAL QUANTITIES HAVE BEEN INCLUDED IN THE QUANTITY SUMMARY FOR BOTH SCENARIOS.

- LEGEND**
- ⬡ SIGN NUMBER
 - ⬡-X PROPOSED SIGNS
 - ⬡-X EXISTING SIGN TO BE REMOVED
 - ⬡-X EXISTING SIGN TO BE RELOCATED

- Ⓐ REFL PAV MRK TY I (W) (4") (SLD)
- Ⓑ REFL PAV MRK TY I (W) (8") (SLD)
- Ⓒ REFL PAV MRK TY I (W) (36") (YLD TRI)
- Ⓓ REFL PAV MRK TY I (W) (24") (SLD)
- Ⓔ REFL PAV MRK TY I (W) (WORD)
- Ⓕ REFL PAV MRK TY I (W) (ARROW)
- Ⓖ REFL PAV MRK TY I (Y) (4") (SLD)
- Ⓗ REFL PAV MRK TY I (Y) (4") (BRK)
- Ⓘ RAISED PAV MRK CL B (REFL) TY I-C
- Ⓝ RAISED PAV MRK CL B (REFL) TY II-A-A
- Ⓚ REFL PAV MRK TY I (W) 8" (DOT)
- Ⓛ REFL PAV MRK TY II (Y) (4") (SLD)
- Ⓜ BI-DIRECTIONAL DELINEATOR
- Ⓝ DELINEATOR
- Ⓞ OBJECT MARKER (OM-2)
- Ⓟ OBJECT MARKER (OM-3)

- NOTES:**
1. FINAL LOCATION OF ALL PROPOSED SIGNS MAY BE ADJUSTED IN THE FIELD AS DIRECTED BY THE ENGINEER.
 2. UNLESS OTHERWISE NOTED, EXISTING SIGNS TO REMAIN IN PLACE.



Tommy G. Levario
 11/2/16

DATE	BY	REV	REVISION
11/02/16	NA	1	CULVERT REVISION

DANNENBAUM
 ENGINEERING COMPANY - AUSTIN, LLC
 T.B.P.E. FIRM REGISTRATION #8995
 1489 EXECUTIVE CENTER DR., STE 129 AUSTIN, TX 78731 (512) 345-8505

© 2015 BY WILLIAMSON COUNTY, TEXAS; ALL RIGHTS RESERVED.

**CR 110 SOUTH
 PAVEMENT
 MARKINGS AND
 SIGNING PLANS**

STA 194+00 TO END
 SCALE: HORIZONTAL 1"=100'

SHEET 5 OF 6

DESIGNED:	TGL		
DRAWN:	PRP		
CHECKED:	GV		
STATE:	COUNTY:	PRECINCT:	SHEET NO.:
TEXAS	WILLIAMSON	4	242

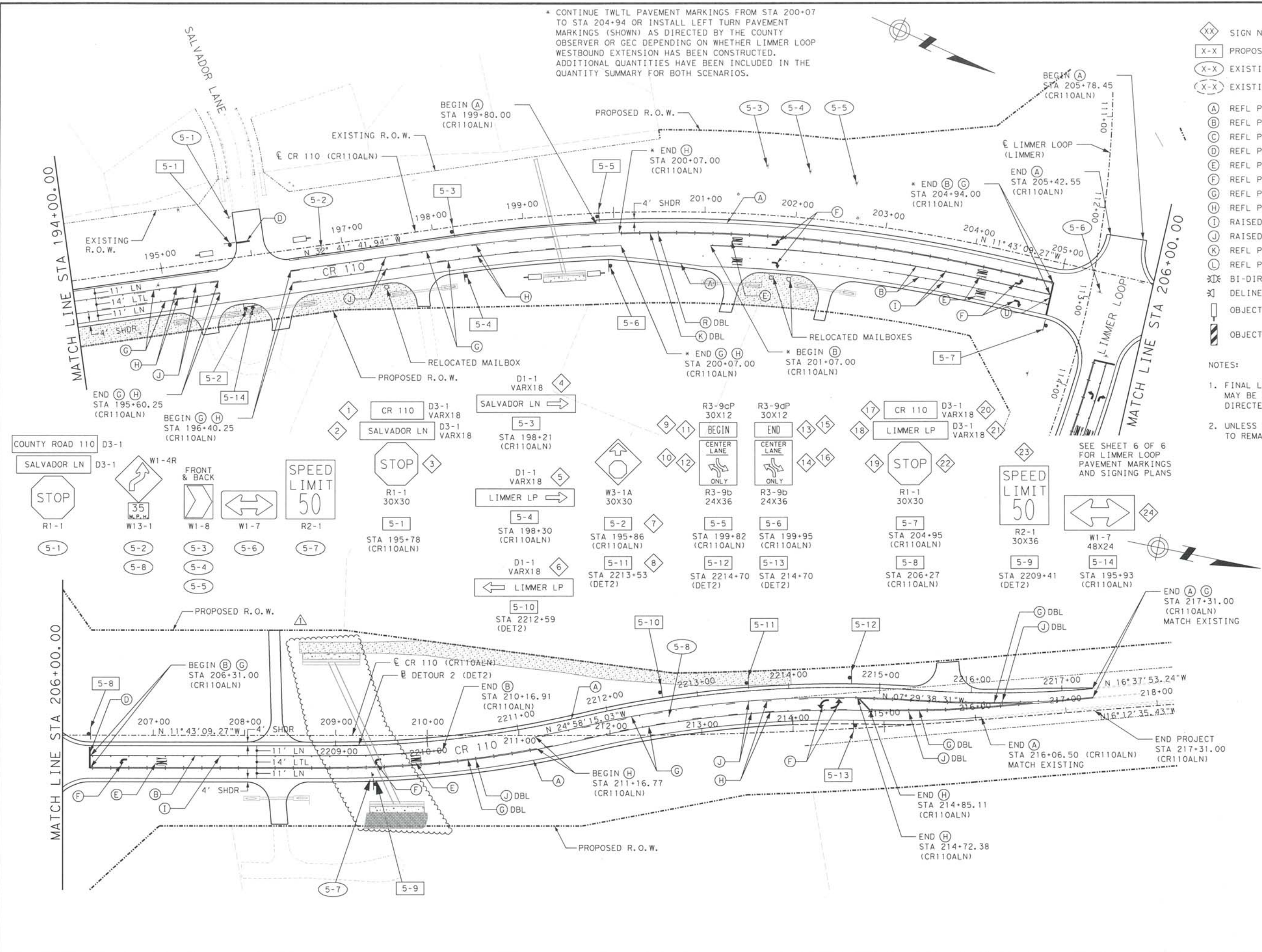

SEE SHEET 6 OF 6 FOR LIMMER LOOP PAVEMENT MARKINGS AND SIGNING PLANS



* INSTALL RIGHT TURN ONLY PAVEMENT MARKINGS AND SIGNS AS DIRECTED BY THE COUNTY OBSERVER OR GEC.

LEGEND

- XX SIGN NUMBER
- X-X PROPOSED SIGNS
- X-X EXISTING SIGN TO BE REMOVED
- X-X EXISTING SIGN TO BE RELOCATED
- A REFL PAV MRK TY I (W) (4") (SLD)
- B REFL PAV MRK TY I (W) (8") (SLD)
- C REFL PAV MRK TY I (W) (36") (YLD TRI)
- D REFL PAV MRK TY I (W) (24") (SLD)
- E REFL PAV MRK TY I (W) (WORD)
- F REFL PAV MRK TY I (W) (ARROW)
- G REFL PAV MRK TY I (Y) (4") (SLD)
- H REFL PAV MRK TY I (Y) (4") (BRK)
- I RAISED PAV MRK CL B (REFL) TY I-C
- J RAISED PAV MRK CL B (REFL) TY II-A-A
- K REFL PAV MRK TY I (W) 8" (DOT)
- L REFL PAV MRK TY II (Y) (4") (SLD)
- X-BI-DIRECTIONAL DELINEATOR
- XI DELINEATOR
- OBJECT MARKER (OM-2)
- ▨ OBJECT MARKER (OM-3)

NOTES:

1. FINAL LOCATION OF ALL PROPOSED SIGNS MAY BE ADJUSTED IN THE FIELD AS DIRECTED BY THE ENGINEER.
2. UNLESS OTHERWISE NOTED, EXISTING SIGNS TO REMAIN IN PLACE.

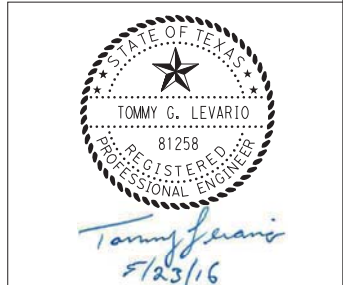

DATE	BY	REV	REVISION

DANNENBAUM
ENGINEERING COMPANY - AUSTIN, LLC
T.B.P.E. FIRM REGISTRATION #8995
3409 EXECUTIVE CENTER DR., STE 129 AUSTIN, TX 78731 (512) 345-8505

© 2015 BY WILLIAMSON COUNTY, TEXAS; ALL RIGHTS RESERVED.

CR 110 SOUTH
PAVEMENT
MARKINGS AND
SIGNING PLANS

SCALE: HORIZONTAL 1"=100'

SHEET 6 OF 6

DESIGNED:	TGL		
DRAWN:	PRP		
CHECKED:	GV		
STATE:	COUNTY:	PRECINCT:	SHEET NO.:
TEXAS	WILLIAMSON	4	243

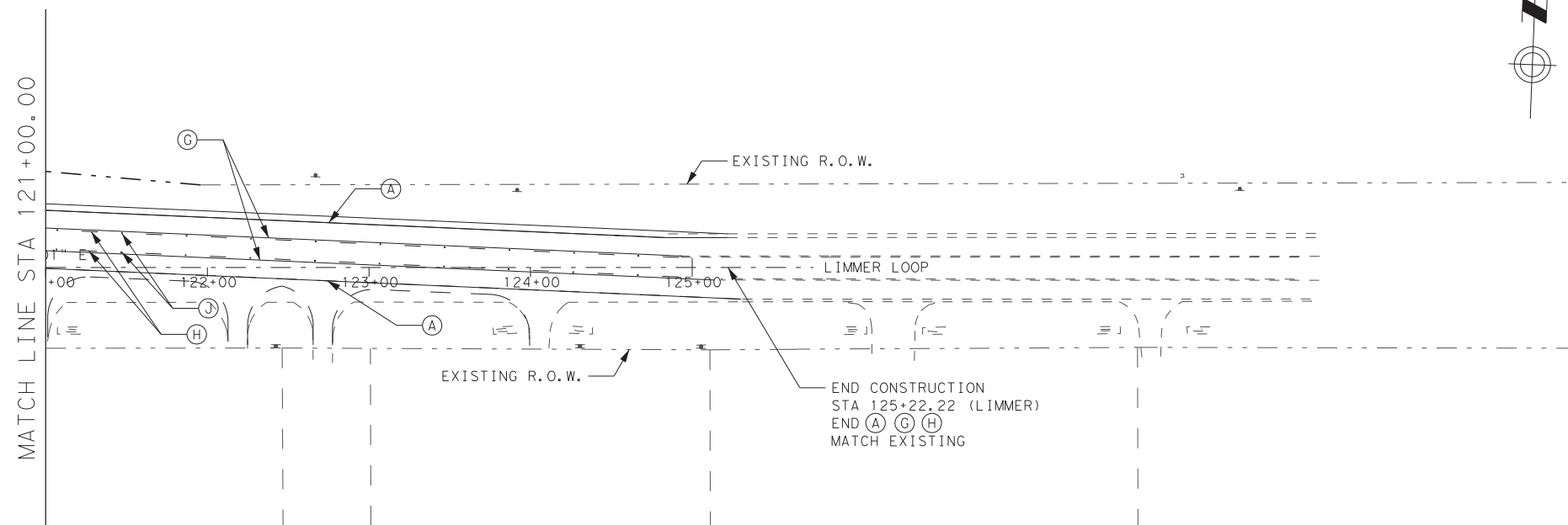
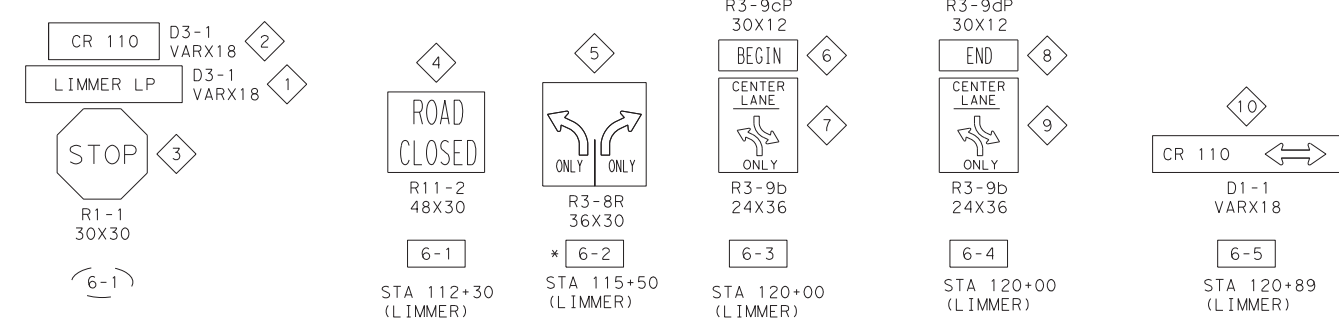
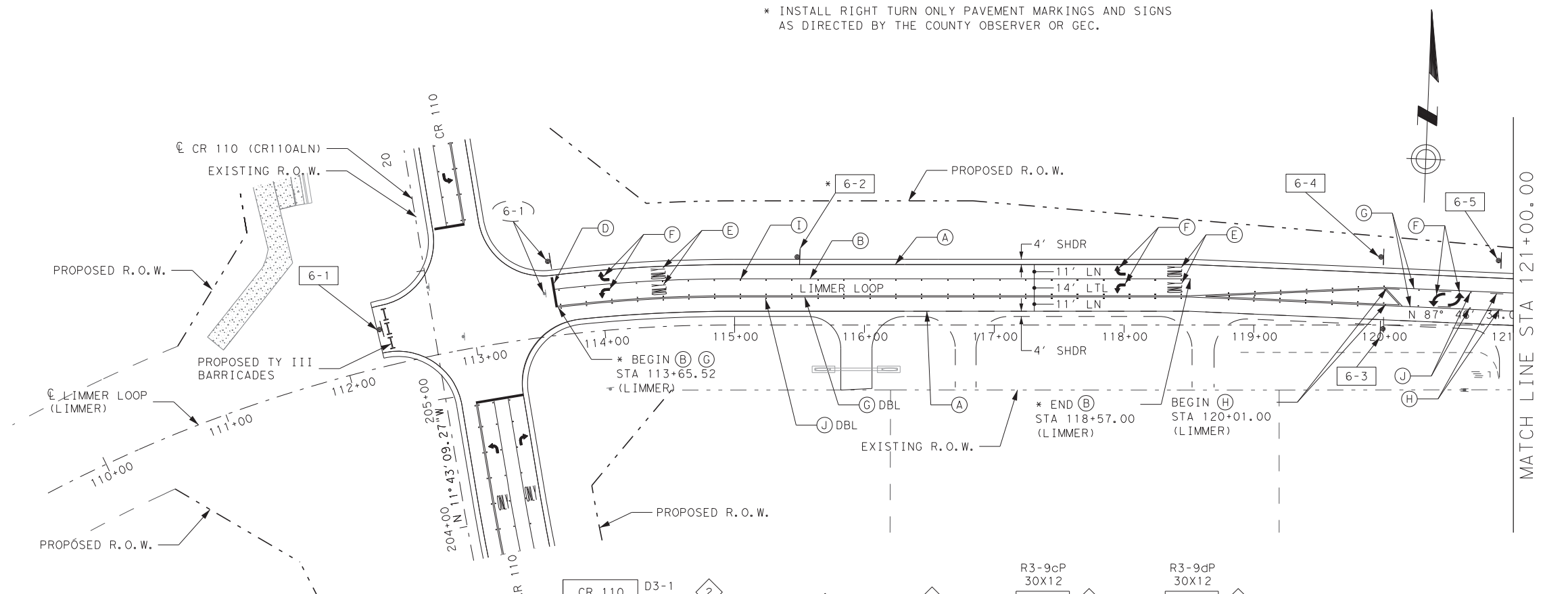

FILE: pw:\usb-hou-pw01.dannenbaum.local\1.dannenbaum\Documents\Transport\ton\4862-01\Design\Sign\tr\ip\ing\48625TP06
 DATE: 5/23/2016 TIME: 2:59:13 PM USER: nojib.ozouggh